

Installation Guide

Shower Arm, Internal Pipe Connection

02-009613

Intended use

The Shower Arm for internal pipe connection is designed to facilitate the installation of the T-safe Easy-Fix Shower Filter or the T-safe Medical Fixed Shower Filter.

Note: Before beginning the installation, ensure that all required parts are included.

Parts included:

- 3 mm Allen Key
- 2 screws
- 2 wall plugs
- 1 shower arm
- 1 base plate
- 1 pipework

T-safe A/S

Gydevang 1
3450 Allerød, Denmark

+45 48 17 22 82
info@t-safe.com
www.t-safe.com

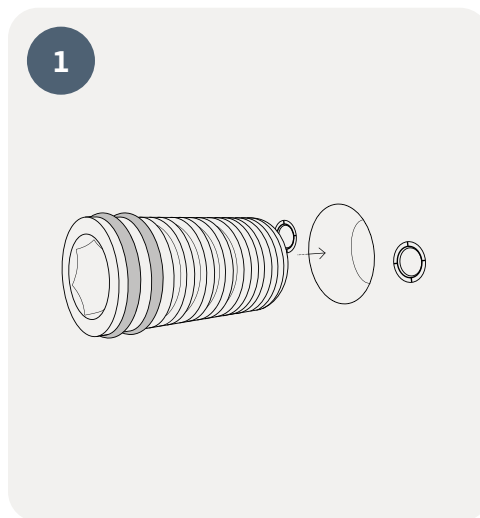

Installing the base: Mark and drill two holes using an 8 mm drill bit. Insert the wall plugs, ensuring they are flush with the wall. Secure the threaded pipework connection to the water supply pipework.

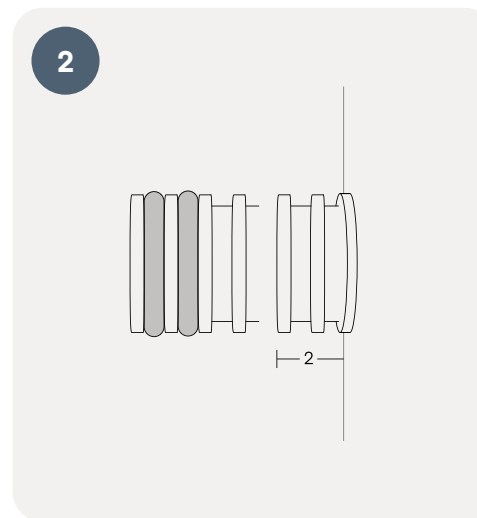

Cut the pipework connection, leaving two indents exposed from the wall. Unscrew the pipework, apply an appropriate sealing material to prevent leaks, and then securely screw it back in place.

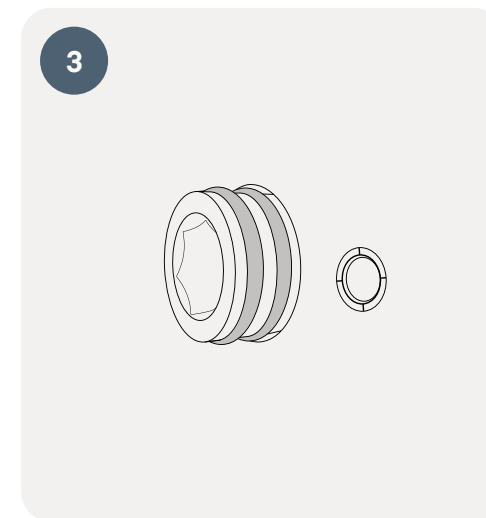

Place an O-ring onto each indent (two in total).

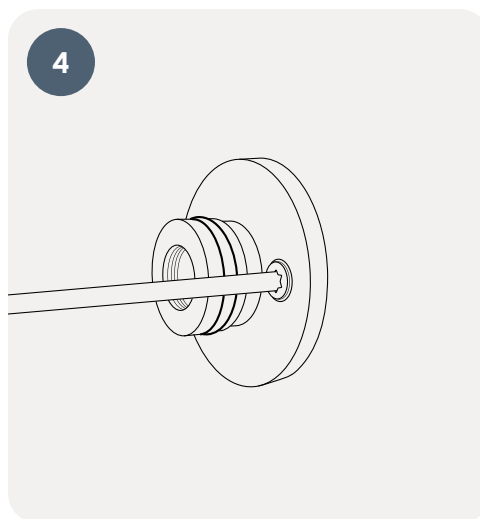

Secure the base plate to the wall using the provided screws.

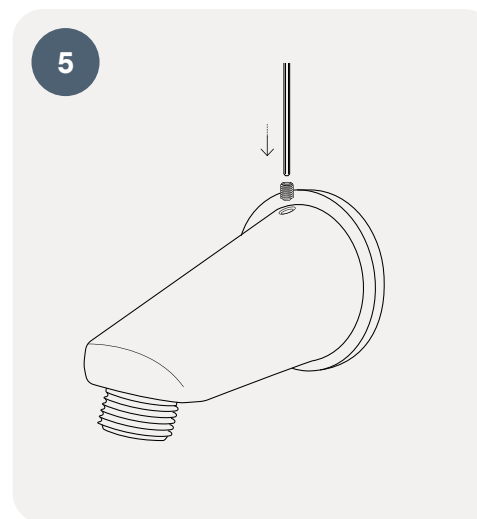

Attach the shower arm to the base plate and secure it using the grub screw.



Connect the T-safe Easy-Fix Shower Filter (02-092031) or the T-safe Medical Fixed Shower Filter (02-092034) to the shower arm using the 1/2" threaded connection.