

Installation Guide

Shower Panel Adapter f. Horne VR

90-001882

Intended use

This two-part shower panel adapter is intended to facilitate the installation of the T-safe Easy-Fix Shower Filter or the T-safe Medical Fixed Shower Filter to Horne VR shower panels/heads.

The shower panel adapter is compatible with the following Horne surface mounted shower panels:

- **T105**
A, T4, T9, B, ALR, T4LR, T9LR, BLR, A2L, T42L, T92L, B2L

The shower panel adapter is compatible with:

- **Horne fixed vandal resistant shower head**

T-safe A/S
Gydevang 1
3450 Allerød, Denmark

+45 48 17 22 82
info@t-safe.com
www.t-safe.com

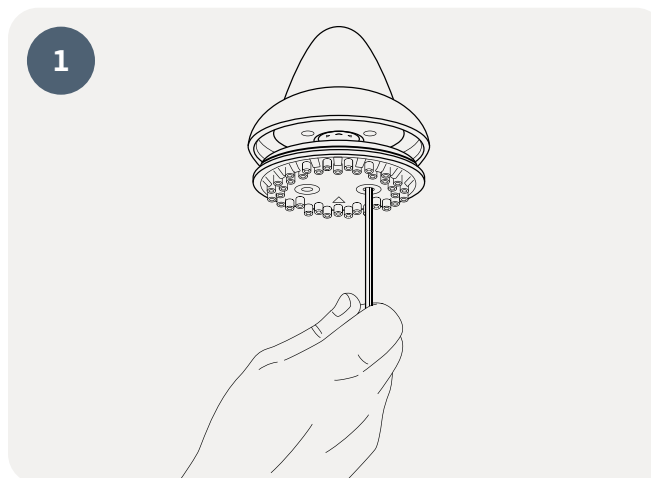

Remove the spray plate and O-ring from the Horne shower head using a 3 mm Allen Key.
Keep both the spray plate and O-ring in a safe place so it can be reinstalled later if necessary.



Unscrew the two parts of the adapter (90-001882) from each other by hand. Insert the base part into the Horne shower head and fasten it tightly using the original screws from the shower head and a clean 3 mm Allen key.

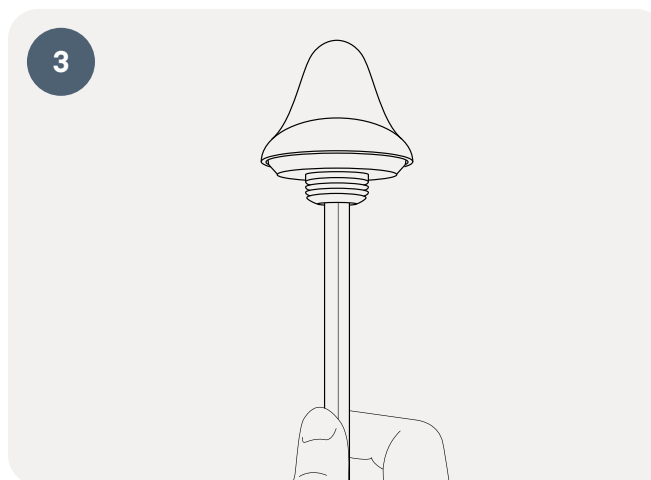

Insert the other part of the adapter and screw it in loosely by hand. Then, secure it tightly using a clean 12 mm Allen key.



Connect the T-safe Easy-Fix Shower Filter (02-092031) or the T-safe Medical Fixed Shower Filter (02-092034) to the 1/2" thread.

Note: The shower panel will not maintain its vandal-resistant or anti-ligature properties after the installation of this adapter.